

UNSHIELDED SMD POWER INDUCTORS / FPI TYPE

FEATURES

- ◆ Silver Plated Type
- ◆ High power and high saturation
- ◆ Ideal inductors for DC/DC conversion



APPLICATIONS

- ◆ Power supply for VTRs.
- ◆ Portable communication equipment.
- ◆ Notebook PCs.
- ◆ LCD televisions.
- ◆ DC/DC converters, etc.

ORDERING CODE

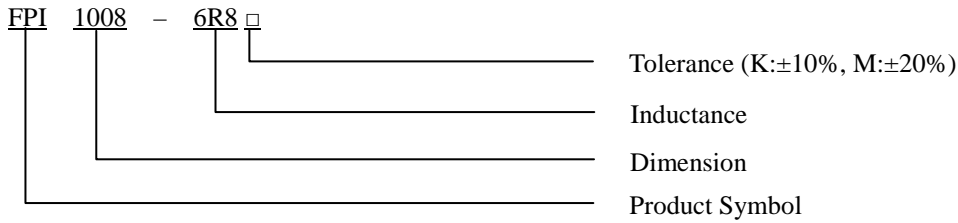

DIMENSIONS (UNIT: mm)

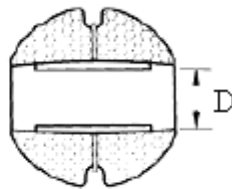
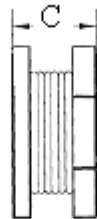
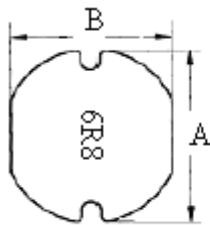

A	10.0 ± 0.4	m/m
B	9.0 ± 0.4	m/m
C	8.2 ± 0.3	m/m
D	3.1 (REF)	m/m

UNSHIELDED SMD POWER INDUCTORS / FPI TYPE

ELECTRICAL CHARACTERISTICS FOR FPI1008

Part No.	Inductance (uH)	RDC (Ω)	IDC (A)
FPI1008-6R8 □	6.8	0.026	9.50
FPI1008-100 □	10	0.028	8.00
FPI1008-150 □	15	0.040	6.40
FPI1008-220 □	22	0.052	5.00
FPI1008-330 □	33	0.055	4.50
FPI1008-470 □	47	0.111	3.80
FPI1008-680 □	68	0.130	3.30
FPI1008-820 □	82	0.150	3.00
FPI1008-101 □	100	0.175	2.00
FPI1008-221 □	220	0.350	1.70
FPI1008-331 □	330	0.580	1.30
FPI1008-471 □	470	0.780	1.10
FPI1008-681 □	680	1.180	0.95
FPI1008-102 □	1000	1.650	0.60

* 100uH 以上 Test Frequency : 1KHZ/1V

* 100uH 以下 Test Frequency : 2.52MHZ/1V



CORE MASTER ENTERPRISE CO., LTD.

<http://www.coremaster.com.tw>